

Specification Sheet

USB2.0 Flash Drive
AH137



Table of Contents

1. Product Introduction.....	3
2. Product Features.....	3
3. Specifications.....	4
4. Physical Dimension.....	4
5. Revision History.....	5

1. Product Introduction

In response to the global concern for environmental protection, Apacer indicates that most 3C products in the market mainly feature modern technological style. Nevertheless, Apacer's is committed to integrating natural elements into product design, bringing people closer to nature, which offers more profound user experience and conveys the respects toward nature. From tree-originated AH135 to bamboo-inspired AH137, they are the crown jewel of Apacer's design.

AH137 feature bamboo-like curvaceous and streamlined enclosure for firmer hold and better plugging/unplugging. AH137 also show thought-out details with the special pen cap design to prevent accidental loss of cap. This detailed design demonstrates Apacer's consideration for ergonomics. With "simulation" of the upward growth of bamboo joints, users can build "step-by-step" body by combining various AH137 models, which renders interesting user experience.

2. Product Features

- High-speed USB 2.0 certified, backwards compatible with USB 1.1
- USB powered. No external power required.
- Compact and slim
- Bamboo-shape design
- Advanced COB technology with water-proof, dust-proof and shock-proof functions
- RoHS compliant

3. Specifications

Specifications	
Interface	High-speed USB 2.0 certified, backwards compatible with USB 1.1
Power supply	USB bus powered; No external power required
Operating Systems Supported	Windows 7/XP/2000/Vista, Mac OS 8.6 and Linux 2.4.0 or above
Capacity	4GB-32GB
Operating Temperature	0° C to +60° C (32° F to 140° F)
Storage Temperature	-20° C to +60° C (-4° F to +140° F)
Dimensions	(L)33.4 x (W)20.2 (H)11.3mm
Weight	6g
Certificate	CE, FCC, BSMI

4. Physical Dimension

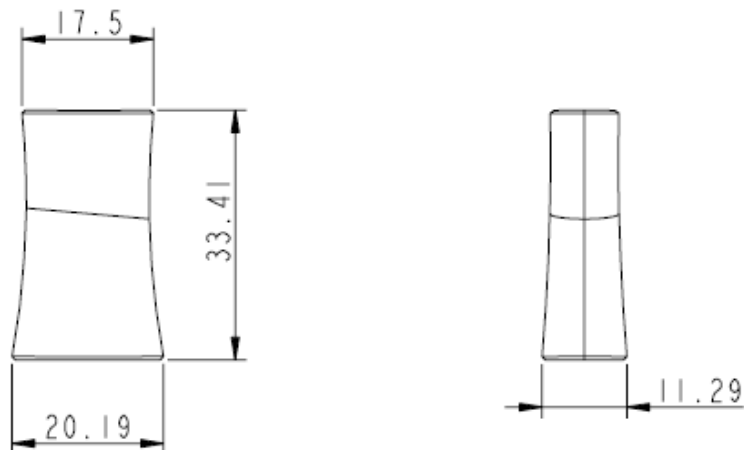

Unit: mm

5. Revision History

Revision	History	Date	Remark
1.0	Official release	Nov. 15,2012	