

Apacer AS710

The SSD with both SATA and USB Interfaces for Easy PC Upgrade

Ever think of upgrading your PC storage system but hesitate for the multi-step installation? For those with considerable experience and knowledge in computers and electronic devices, SSD installation is not that difficult. However, for others without the time, knowledge or experience in such fields, they might be anxious about backing up data, taking out the old hard drive, replacing with an SSD by connecting it to a SATA port on motherboard and then perhaps some BIOS setting and disk management. Now, Apacer has the answer.

Apacer has launched AS710 SSD featuring both SATA and USB interfaces. The additional USB port will definitely make it easier for users to have fast data access and files backup without the needs of lengthy installation process and operation system re-installation. Better yet, no converter cable is needed.

AS710 not only offers easier uses, but also features system boost capabilities. Built with a powerful SATA 6.0 Gbps controller, the drive can deliver up to 550 MB/s for read and 530 for write, with IOPS up to 50,000 for read and 70,000 for write. Though not unsurpassable, the performances are highly effective. The controlling core of the drive fully complies with the latest SATA 6.0 Gbps interface standard and backward compatible with its previous 1.5/3.0 Gbps, so that no worry about compatibilities. In addition, the USB interface supports USB 3.0 Super Speed specification that delivers ideal data access/transfer with ease.

Applications

- PC/NB for general storage
- Operating system boot drive for PC/NB
- Portable storage
- Graphic and video applications
- Multimedia
- Gaming

Features:

- SATA 6.0 Gb/s interface
- USB 3.0 interface
- Capacity: 128 GB
- Outstanding read/write performance via USB interface: up to 380 MB/s for read and 420 MB/s for write*
- Terrific sequential read/write via SATA interface: up to 550 MB/s for read and 530 MB/s for write
- ECC engine correcting up to 55bit/512-byte sector
- Easy data storage & backup via USB connection
- Portable storage applications
- Exceptional IOPS: up to 50,000 IOPS at 4KB random read and 70,000 IOPS at 4KB random write*
- Supports S.M.A.R.T. commands
- Wear leveling
- Sudden Power Off Recovery
- RoHS, CE, FCC & VCCI certifications
- Supports NCQ commands

*Results may vary depending on host system platforms (measured under ATTO and IOMeter)

Mechanical Dimensions:

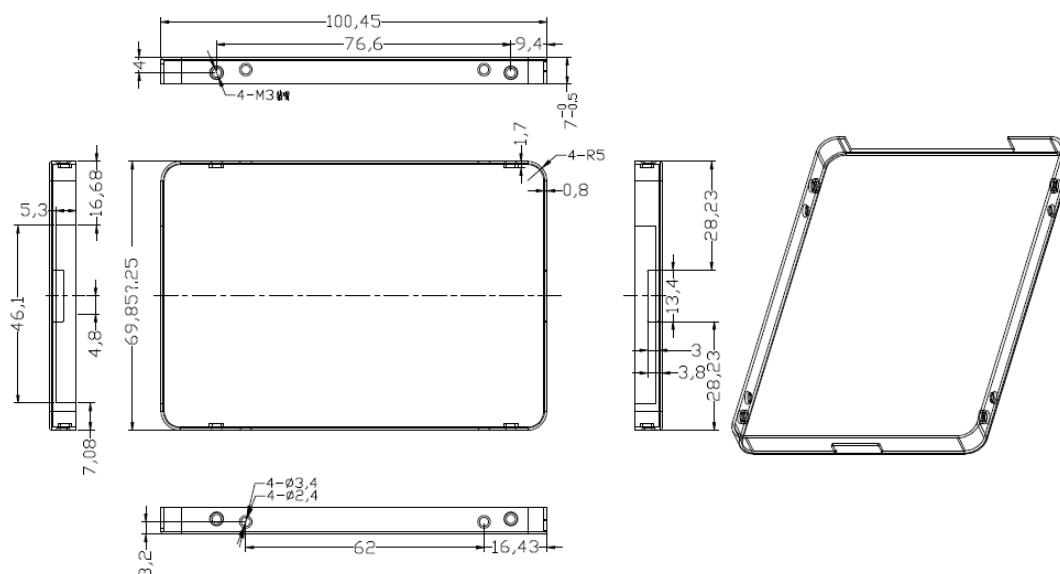

Unit: mm

SATA SSD AS710



General Product Specifications

Specifications		
Interface	SATA 6.0 Gb/s interface, backward compatible with 1.5/3.0 Gbps interfaces USB 3.0 Super Speed specification compliance, backward compatible with USB 1.1/2.0 interface specifications	
Capacity*	128 GB	
Performance**	Via USB	Sequential Read: up to 380 MB/s Sequential Write: up to 420 MB/s
	Via SATA	Sequential Read: up to 550 MB/s Sequential Write: up to 530 MB/s
	Random 4K Read: 50,000 IOPS Random 4K Write: 70,000 IOPS	
Form Factor	2.5 inch	
NAND Flash Media	MLC	
ECC	up to 55bit/1KB	
Operating Voltage	5V \pm 5%	
Power consumption***	Active: 1.8 W Standby: 0.5 W	
Dimension	100.10mm(L) x 69.85mm(W) x 7.00mm(H)	
Reliability Features	S.M.A.R.T, Wear-leveling, ECC (up to 55bit/512-byte sector), NCQ, sudden power-off recovery, DuraWrite Technology	
Temperature	Operating	0°C to 70°C
	Storage	-40 ~ +85°C
Humidity	Operating: 25°C, 8% to 95% non-condensing Non-operating: 40°C, 8% to 93% non-condensing	
Shock****	Half sine 3000G/0.3ms	
Vibration****	Sine 30G, 10 ~ 2000Hz	
Warranty	3 years	
Package Content	Retail package	
Certifications	RoHS, CE, FCC, VCCI	

*Unformatted. Theoretically, 1GB=1,000,000,000 Bytes. Under operating systems, the capacity might appear to be less than the theoretical capacity because the calculation in OS is based on 1 GB = 1024 MB / 1MB =1024KB and a minority of the capacity is reserved for maintenance purposes.

**Performance results may vary from flash configurations or host system settings (measured under ATTO and IOMeter).

***Power consumption were measured at 5V and results may vary from flash configurations or host system settings.

****Shock and vibrations are subject to change without notice

Global Offices

Taiwan (HQ)

Apacer Technology Inc.

1F, No.32, Zhongcheng Rd.,
Tucheng Dist., New Taipei City
Taiwan 221
R.O.C.
Tel: +886-2-2267-8000
Fax: +886-2-2267-2261
amtsales@apacer.com

U.S.A

Apacer Memory America, Inc.

386 Fairview Way, Suite102,
Milpitas, CA 95035
Tel: 1-408-518-8699
Fax: 1-408-935-9611
sa@apacerus.com

Japan

Apacer Technology Corp.

5F, Matsura Bldg., Shiba, Minato-Ku
Tokyo, 105-0014, Japan
Tel: 81-3-5419-2668
Fax: 81-3-5419-0018
jpservices@apacer.com

Europe

Apacer Technology B.V.

Science Park Eindhoven 5051 5692
EB Son,
The Netherlands
Tel: 31-40-267-0000
Fax: 31-40-267-0000#6199
sale@apacer.nl

China

Apacer Electronic (Shanghai) Co., Ltd

1301, No.251,Xiaomujiao Road,
Shanghai,
200032, China
Tel: 86-21-5529-0222
Fax: 86-21-5206-6939
sales@apacer.com.cn

India

Apacer Technologies Pvt Ltd,

535, 1st Floor, 8th cross, JP Nagar
3rd Phase,
Bangalore – 560078, India
Tel: 91-80-4152-9061
Sales_india@apacer.com

SATA SSD AS710



Revision History

Version	Description	Date
0.1	Preliminary release	12/18/2013
0.2	Revised the existing performance information and added SATA sequential performance	12/20/2013
1.0	Official release	04/16/2014